

Wilder House

ST PAULS

APPROXIMATE FLOOR AREA
42.7 SQM / 460 SQFT



FIFTH FLOOR
460 sq.ft. (42.7 sq.m.) approx.

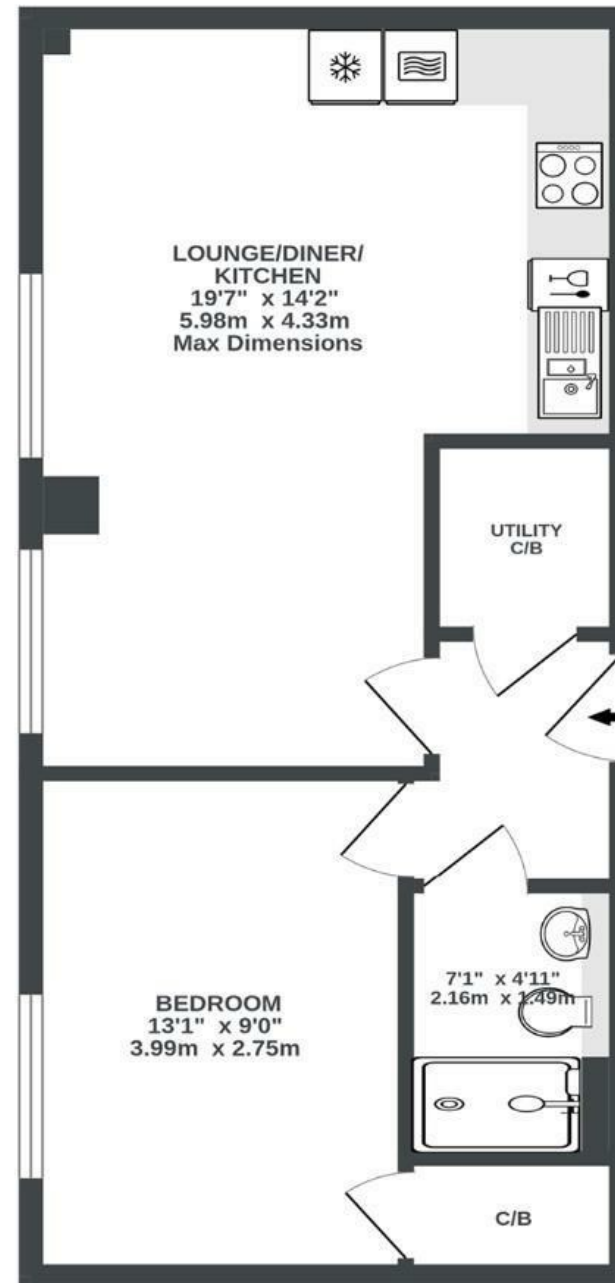

Illustrations are for reference purposes only, measurements are approximate, not to scale.

Boardwalk

Wilder Street

ST PAULS, BRISTOL



£240,000



1 Bedrooms



Bristol, BS2

8PH



1 Bathrooms

"Living in the heart of Bristol's most vibrant and culturally celebrated area has been fantastic and I've absolutely loved my time in Wilder House. Being able to experience the incredible food, art and music scenes right on our doorstep, has been something truly special - all the time spent soaking this up has left us feeling a real part of the friendly local community."

"Our flat really feels like home and provides the perfect balance of relaxation and city living. With fantastic views from our windows up on the 5th floor, along with its position and layout means it feels fresh and airy in the summer, yet warm and cosy in the winter, allowing us to enjoy it all year round. The building itself has an amazing community spirit, with friendly neighbours always willing to lend a hand and help each other out, something we've been grateful for on a number of occasions."

